

# *BinSafe*

Motorized Trolley

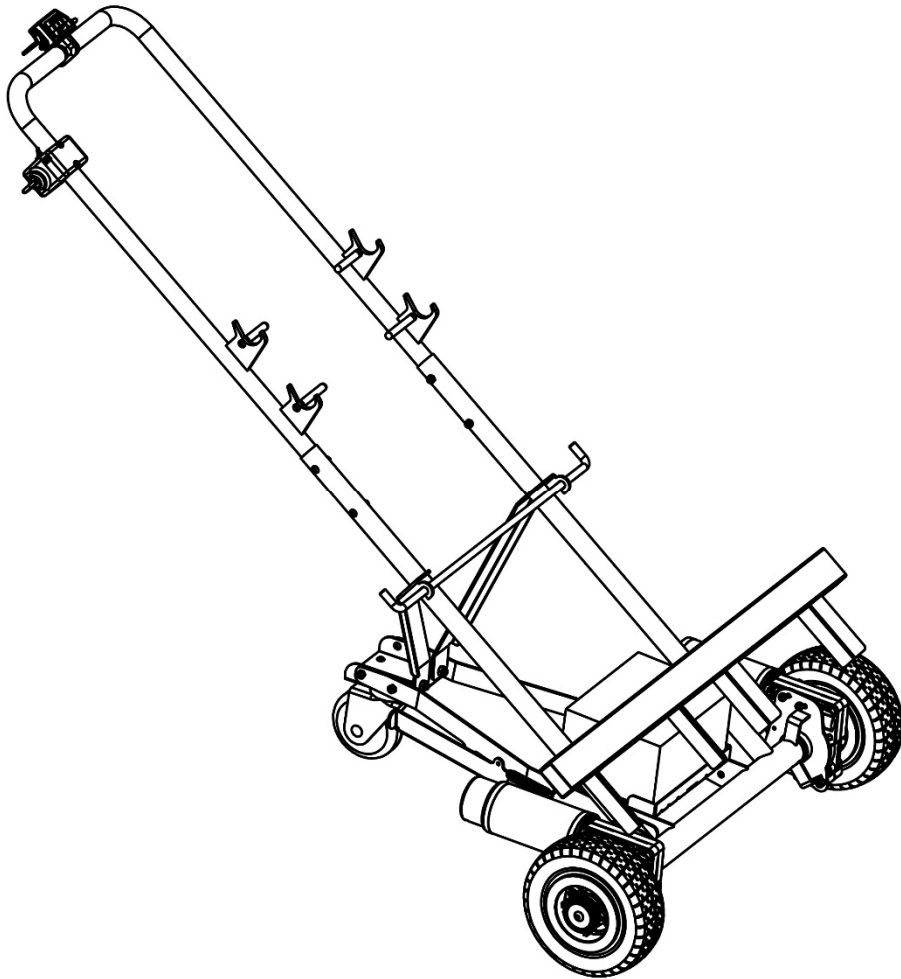

## **User Manual**

You must read this manual before using your BinSafe trolley



**PO Box 1468 Auburn St. Wollongong NSW 2500**

**Phone: 1300 763 444 Fax: +61 2 4226 2208**

**Email: [sales@spacepac.com.au](mailto:sales@spacepac.com.au) ABN 98 002 454 462**

**[WWW.SPACEPAC.COM.AU](http://WWW.SPACEPAC.COM.AU)**

**P/N: 9023100**

Rev. 01/16

## Table of contents

Contents	Pages
Safety Symbols, Words and Labels- - - - -	-2
Safety Instructions - - - - -	-3
Electromagnetic Interference - - - - -	-4
Assembling the Trolley - - - - -	-5
Drive Wheel Release Mechanism- - - - -	-10
Lights and Switches - - - - -	-11
Auto Switch Off Electronic System- - - - -	-12
Parking the Trolley - - - - -	-13
Precaution - - - - -	-14
Battery and Charging- - - - -	-15
Battery Charger (SLA battery) - - - - -	-17
Battery Care & Maintenance - - - - -	-18
Specifications - - - - -	-19

## SAFETY SYMBOLS, WORDS AND LABELS

### What You Need to Know About Safety Instructions

Warning and Important Safety Instructions appearing in this manual are not meant to cover all possible conditions and situations that may occur. Common sense, caution and care must be exercised when operating or cleaning your Trolley.

Always contact your dealer, distributor, service agent or manufacturer about problems or conditions you do not understand.



WARNING indicates a potentially hazardous situation which, if not avoided, could result in death or serious injury.



CAUTION indicates a potentially hazardous situation which, if not avoided, may result in minor or moderate injury.



Radio wave sources may affect motorized Trolley.

**SAVE THIS MANUAL FOR FUTURE REFERENCE.**

## SAFETY INSTRUCTIONS

### CAUTION

- Please read this manual before using your trolley.
- Do not turn your trolley “On” before you are ready to go.
- Practice operation in an open area free of vehicles, pedestrians and obstacles before using your Binsafe trolley.
- Reduce speed when turning.
- Driving in wet conditions is not recommended.
- Do not operate the Forward/Reverse switch when moving. This could damage your trolley.
- Do not operate the trolley on any slope not approved by your local government authority.
- When the yellow battery light comes on, you should recharge your battery as soon as possible. If the red battery light comes on or is flashing, you should stop immediately and recharge.
- Always switch the power “Off” before leaving your trolley or while it is unattended. You can also disconnect the battery plug before leaving your trolley.
- Do not put your thumb on the Speed Lever before you turn the key switch “On”. This could cause the trolley to move without warning.
- Your key switch must be in the “Off” position before connecting the battery lead.

### WARNING

Do not operate the trolley on slopes not approved by your local government authority and then only in the same direction as the slope and by physically able operators and with fully charged batteries. On no account should the trolley be operated at right angles to slopes exceeding 8 degrees and then only with a balanced load. Great care should be taken at any time when the trolley is unladen.

## ELECTROMAGNETIC INTERFERENCE

### WARNING

: It is important that you understand this information regarding the possible effects of Electromagnetic Interference on your trolley.

The electric trolley may be susceptible to electromagnetic interference, which is electromagnetic energy emitted from sources such as radio stations, TV stations, amateur radio transmitters, two-way radios, and mobile phones. This interference can cause the electronics of trolley to become unstable, resulting in the trolley moving in unintended ways.

**DO NOT USE A MOBILE PHONE WHILE USING YOUR TROLLEY.**  
Never use electronic radio transmitters such as CB, portable computers or mobile phones while using the trolley without first turning “Off” the key switch.

**TURN OFF YOUR TROLLEY AS SOON AS POSSIBLE WHEN EXPERIENCING THE FOLLOWING:**

- Unintended or uncontrollable movement.
- Unexpected brake release

### WARNING

- Do not operate the Forward/Reverse switch when moving. This could damage your trolley.

## ASSEMBLING THE TROLLEY

Remove trolley from carton and raise the trolley off the concrete with wooden blocks or similar objects.

Lift handle "A" as per illustration and remove support arm "B" from trolley.

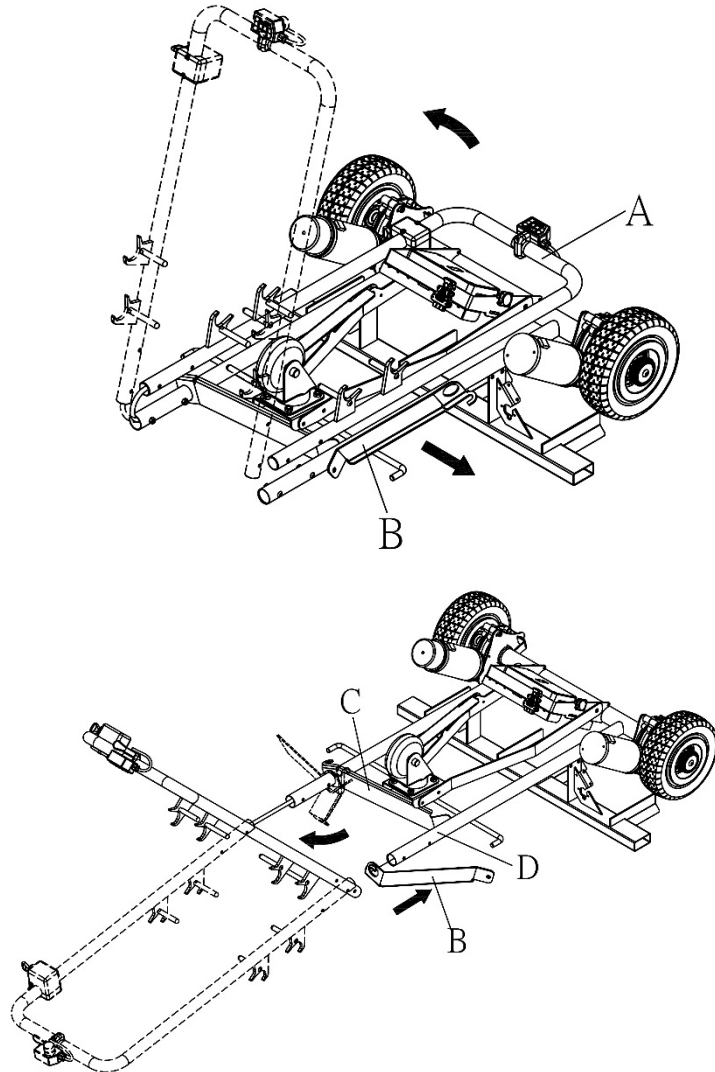

Insert support arm "B" onto the shaft base in the direction of arrow.

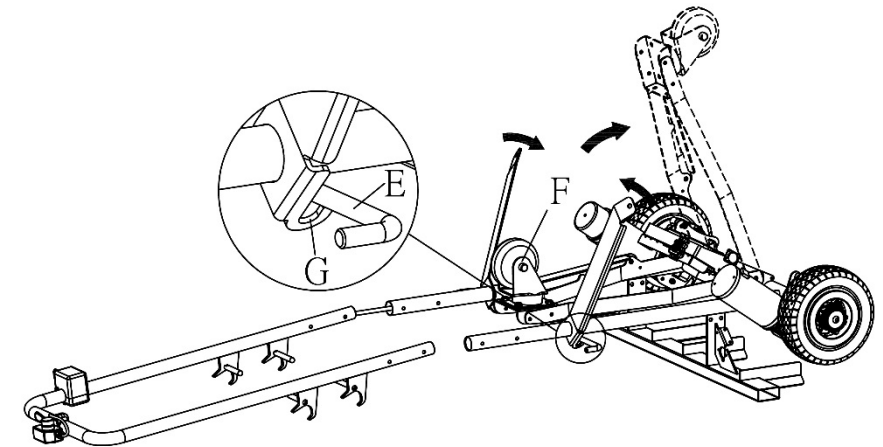
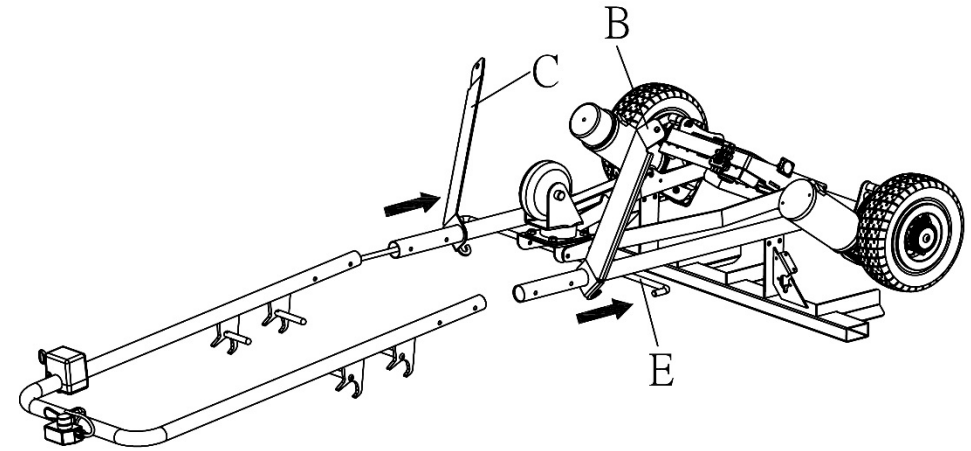

Pull up wheel "F" & frame as per arrow direction.

Swing support arm C & B as per illustration and lock groove "G" onto cross bar "E". Ensure that the groove is locked onto bar "E".

• Assembling the handle

Insert the handle bar into the frame tube as per illustration and insert the bolts through holes "J", then tighten nuts.

CARE: The control cables run down one shaft and may have to be manipulated out of the way before the bolts can be fully inserted.

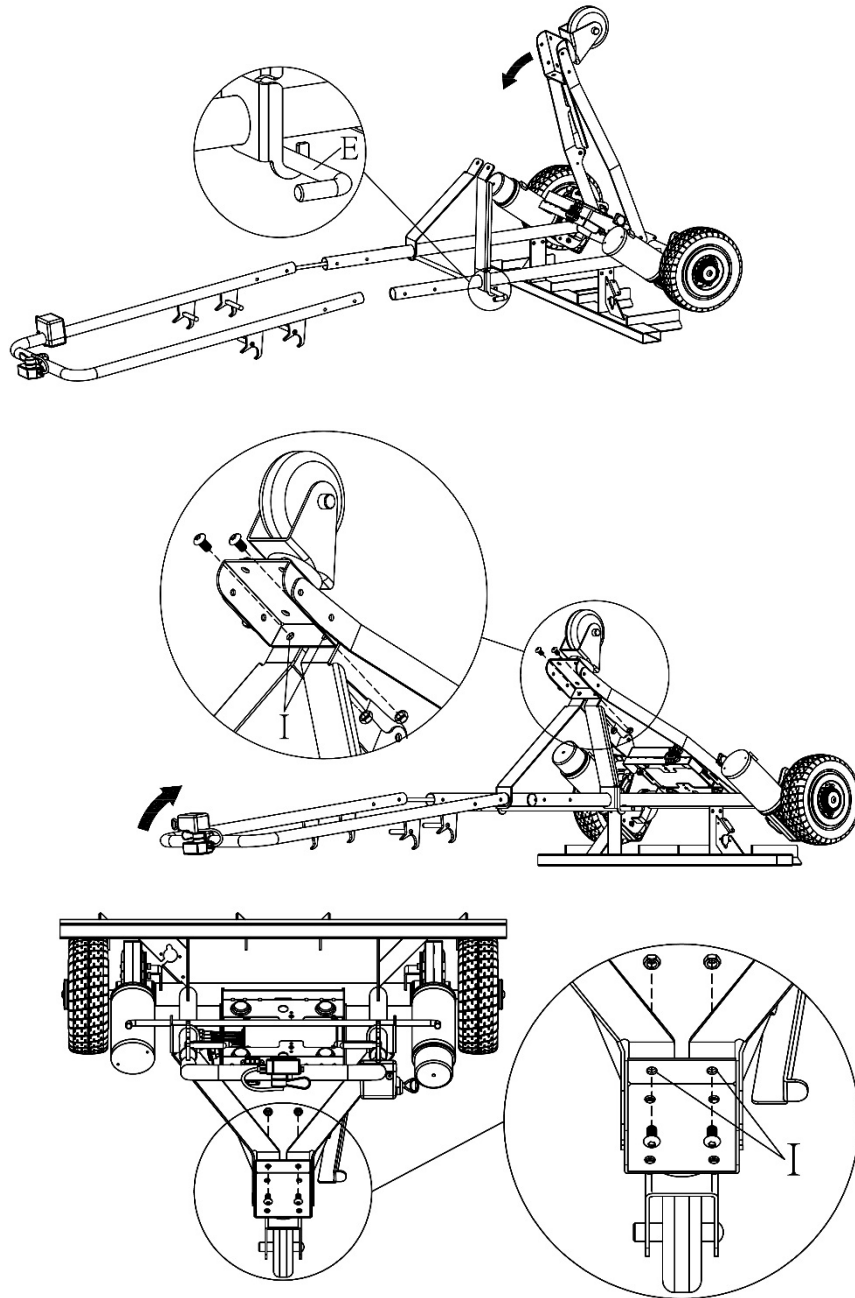

Fix the support arms onto back wheel frame as per illustration.

- Have bolts go through holes "I" and tighten nuts.

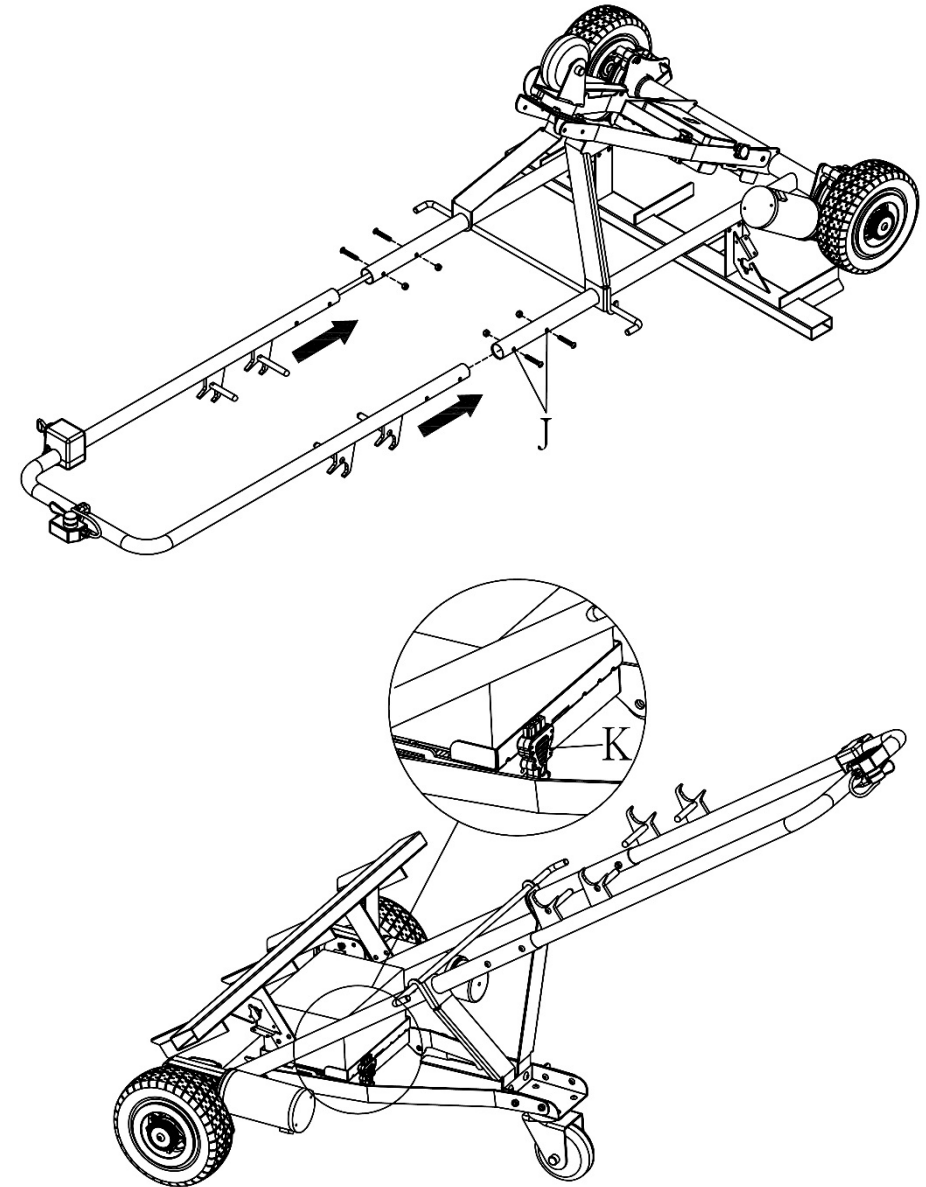

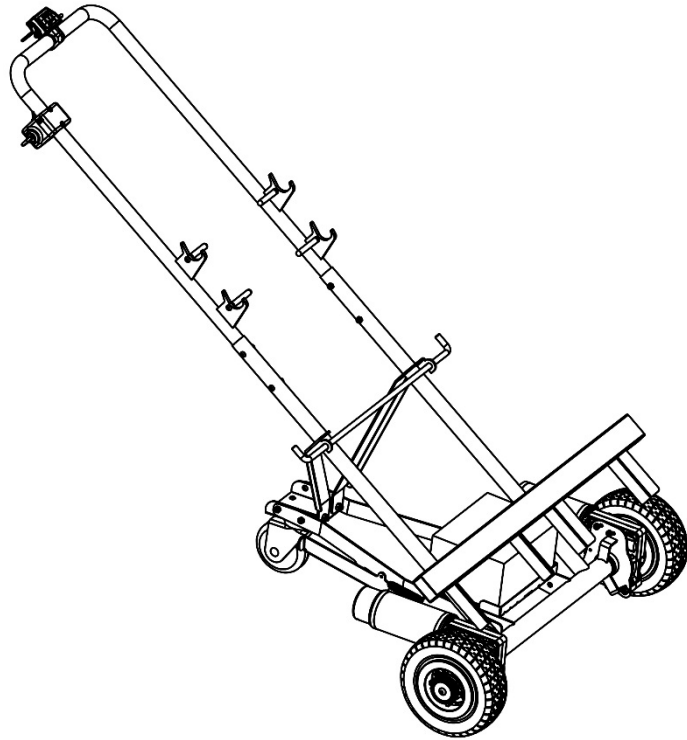

- Install the battery onto the tray and fasten it securely with straps provided.
- Plug in battery plug.
- The connectors are color coded. Don't try to force them into the wrong position.
- Inflate the tyres to a maximum of 40 PSI.

**⚠ WARNING**

**IT IS IMPORTANT THAT YOU TAKE EXTRA CARE TO PRACTICE IN AN OPEN SPACE AWAY FROM OBSTRUCTIONS.**

**NOTE:** Please be aware that should the trolley's wheels meet an obstruction, you will need to help it out manually. Attempting to drive through an obstruction when the wheel is stuck could result in damage.

## DRIVE WHEEL RELEASE MECHANISM

- The trolley is equipped with drive wheel release mechanism. Your trolley can be moved manually after the drive wheels are released.

**⚠ WARNING**

**Do not operate this device while on a slope.**

To disengage the drive wheels  
 Pull the drive collar (part "A") out and turn it left or right, then release it.

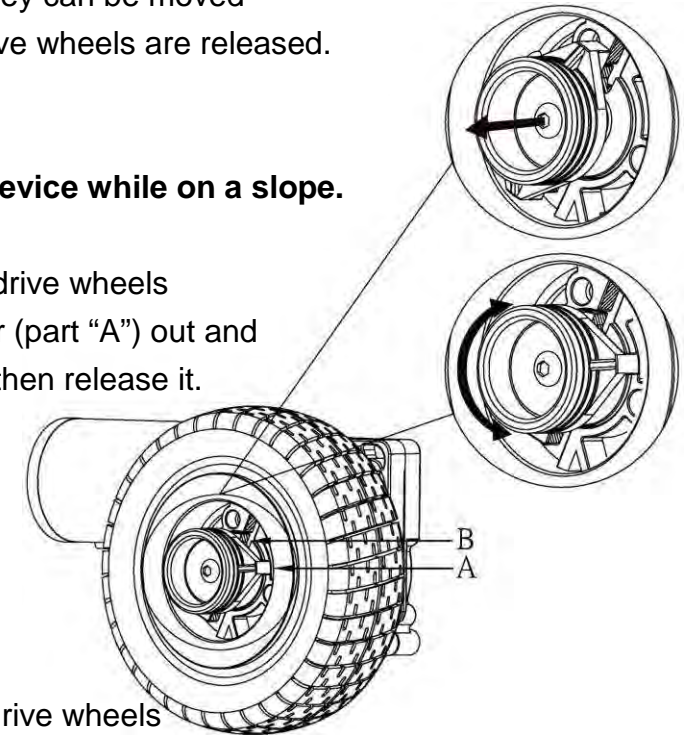

To reconnect the drive wheels  
 Turn the drive collar (part "A") until it reconnects with the wheel and then move the trolley until the collar connects with the drive. (a loud click)

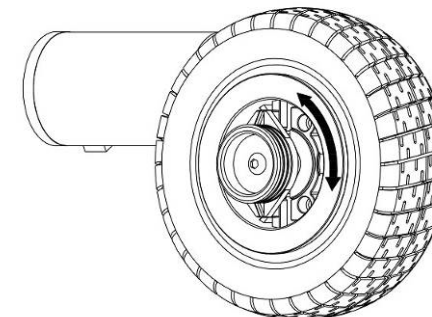

## LIGHTS AND SWITCHES

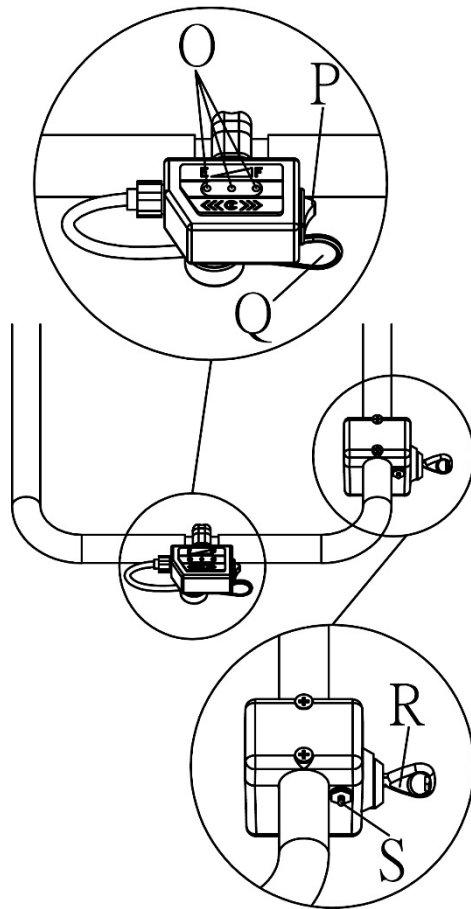

- P : Forward and Reverse switch.
- Q : Speed lever.
- O : Battery level indicator. (for lead-acid battery)
- R : Key switch
- S : Speed selection: F / full speed, S / reduced speed

### NOTE:

The battery gauge on the trolley does not give accurate readings when using a lithium battery.



Do not place your fingers on the speed lever before you turn the key switch “On”.

Do not operate speed selection switch “S” when trolley is moving. Move the speed lever “Q” slowly and accelerate smoothly. Do not push lever “Q” in quickly.

## AUTO SWITCH OFF ELECTRONIC SYSTEM

- The electronic system of this trolley is protected by a digital over current cut-off system. If your trolley stops, you will need to turn the main key switch to the “Off” position, and then switch to “On” position to reset the system.
- Possible causes of over current cut-out are battery not fully charged or near the end of its life, or the slope is too steep for the trolley. Do not continue to overload the system as this may damage the controller.
- The electronic system of this trolley will switch itself “Off” after 3 minutes if the key switch is left in the “On” position when the trolley is not in use. You will then need to turn the key switch to the “Off” position, and then switch to “On” position to reset the control system.

## PARKING THE TROLLEY

- Lift handle bar to almost perpendicular position then push the side post “M” downwards with your foot, as per illustration.

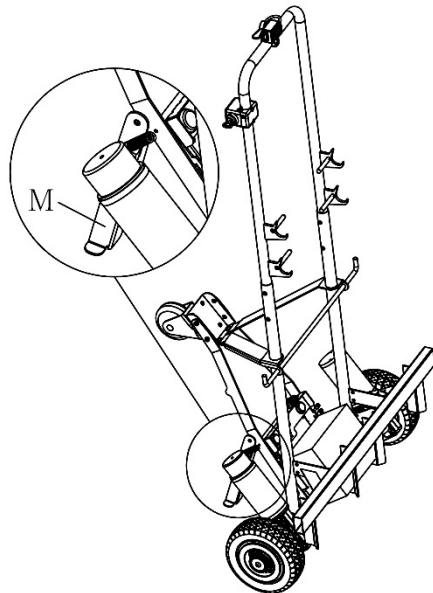
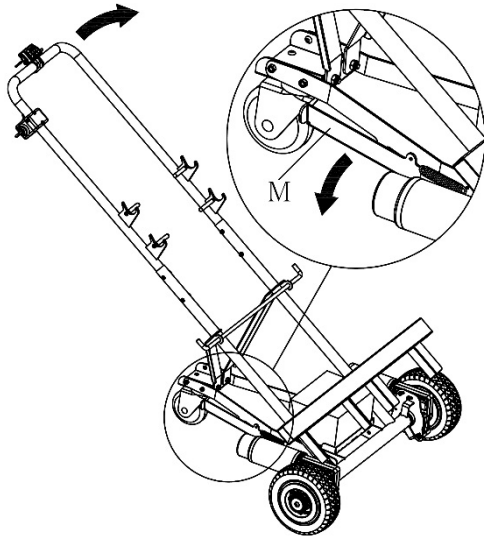

## PRECAUTION

- When using your trolley **for the first time you should practice at slow speed in a flat open area** free of obstacles, until you are confident in turning, stopping, reversing and judging braking distance.
- This trolley is designed for a maximum load weight of 125kgs.
- Always switch power off (Key switch to “Off” position) before leaving your trolley.
- Do not store your trolley outside without adequate protection.
- Keep the shipping carton in dry place after unpacking your trolley in case it needs to be shipped for service.
- This appliance is not intended for use by persons (including children) with reduced physical, sensory or mental capabilities, or lack of experience and knowledge, unless they have been given instructions concerning use of the appliance by a person responsible for their safety. Children should be supervised to ensure that they do not play with the appliance.

### CAUTION

Your trolley is extremely maneuverable but sharp turns must only be done at very slow speed.

Do not operate the Forward/Reverse switch when trolley moving. This could damage your trolley.

Avoid power spray water washing of the trolley as this could cause damage to the wire connectors and electronic system.

Completely dry off the trolley if necessary using a dry cloth after cleaning your trolley.



## BATTERY AND CHARGING

- When you get your new battery put it on charge for at least 24 hours.
- When recharging your battery, always charge for at least 12 hours or until the light on the charger turns green. It is best to charge for at least another hour after the light turns green.
- Never use the battery for any purpose other than to power your trolley.
- The battery charger can become hot during charging so your charger should be placed in a suitable place with good air flow and away from children.

To recharge the batteries, follow the steps below:

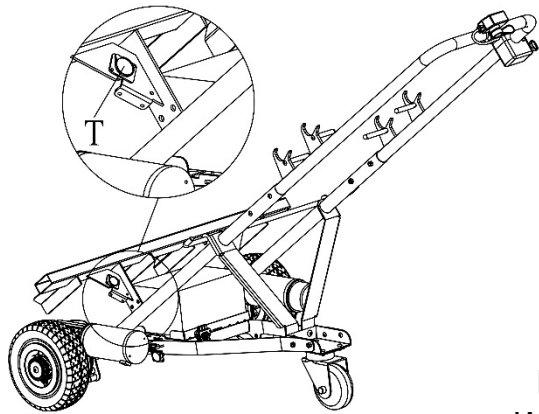

- Place your trolley close to a standard electrical wall outlet.
- Turn the trolley key switch to the "Off" position.
- Plug the charger power cord (round plug) into the socket **indicated on trolley. ( T )**
- Plug the charger power plug into a standard wall outlet.
- When charging is completed, the *yellow* LED will turn to green.
- Disconnect the charger power cord from the wall outlet and the plug from the trolley when the batteries are fully charged.

Or remove the battery from trolley, and use the connection adaptor. (optional accessory)

Do not place the battery on a concrete floor for charging. Raise the battery off the concrete with wooden blocks or similar objects.

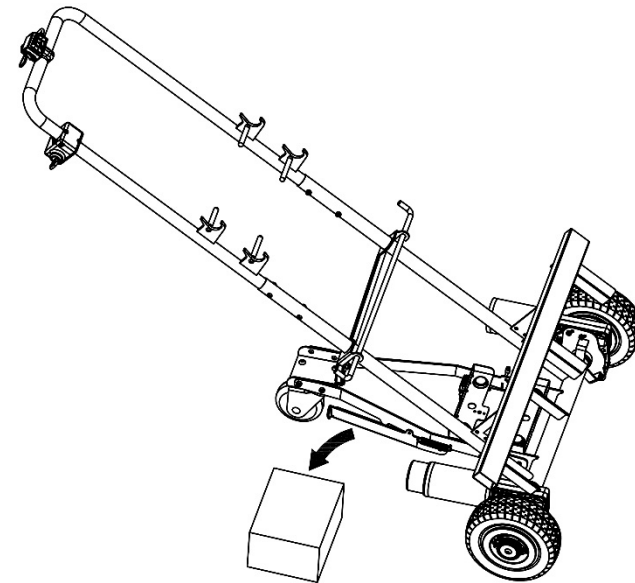



### **IMPORTANT NOTICE:**

The battery terminal covers must be kept in place at all times to avoid the possibility of something falling across the terminals and causing a short circuit. This could damage the battery or even cause it to explode.

To dispose of your battery, return it to your dealer or to a recycler. Improper disposal of the battery could result in an explosion causing injury and/or property damage.

## **BATTERY CHARGER**



- Before charging, read the instructions. (included with charger)
- For indoor use only, do not expose to rain.
- Disconnect the mains power supply before making or breaking the connections to the battery.
- This appliance is not intended for use by persons (including children) with reduced of physical, sensory or mental capabilities, or lack of experience and knowledge, unless they have been given instructions concerning use of the appliance by a person responsible for their safety. Children should be supervised to ensure that they do not play with the appliance.
- This charger is not for recharging non-rechargeable batteries.
- Do not use for charging any batteries not specified by the manufacturer.

## **BATTERY CARE & MAINTENANCE**



### **Important notes to help prolong the life of the battery:**

- Before the first use of your battery, put it on charge for 24 hours.
- Do not place the battery on a concrete floor for charging, have the battery raised off the floor on wooden blocks or place the battery on a bench or shelf.
- To fully charge the battery, choose a place where ambient temperature is above 10 degrees Celsius.
- Always recharge your battery as soon as possible after use.
- When yellow light of trolley is "On" you should recharge your battery as soon as possible.
- Never use the battery when the trolley's red light is "On". You will discharge the battery below its designated voltage and damage it.
- Do not drop the battery.
- **STORAGE:**  
If you know that you will not be using your battery in the near future, disconnect the battery from the trolley and store it in a suitable dry place.  
Recharge your battery before you use it or **every 3 months (No more than 3 months) if it is not used in that period.**
- Always contact our service agent before you replace the battery or the charger. Using an incompatible battery or charger may damage the trolley and void your warranty.

## Specifications

Number of Wheels	3
Front Wheel Size	200mm (8")
Rear Wheel Size	Swivel castor 100mm (4")
Ground Clearance	65mm (2.6")
Length	1280mm (50")
Width	750mm (29.5")
Weight Without battery	Frame : 20kg (44 lbs.)
Max Loading	125kg (275 lbs.)
Motor Output	2 - 180 Watt
Transmission	Worm Drive Gearbox
Reverse	Forward/Reverse Switch
Brakes	Dynamic Braking and Electromagnetic Brake
Battery (SLA/Lithium)	24V – 7.2 ah 5.0kg (11 lbs.) 24V - 15 ah 9.2kg (20 lbs.) / 4.0 kg. (9 lbs.)
Charger (SLA/Lithium)	24 volt 2 amp / 24V 4 amp
Max Speed SLA Battery	5.4 kph. (3.4 mph)
2 <sup>nd</sup> speed choice	3.9 kph (2.4 mph)
Slope Grade Ability	18 Degrees with 120kg (260 lbs) load. 20 Degrees with 100kg (220 lbs) load