

CM PORTABLE LIFTER

The most compact lifter in the world!!

IENA SILVER AWARD, GERMANY
 INPEX GOLDEN AWARD, USA
 Invention show GOLDEN AWARD, TAIWAN
 Invention show GOLDEN AWARD, CHINA
 Patented in USA, CANADA, GERMANY,
 TAIWAN, JAPAN, CHINA, KOREA .



KSF Model	Basic Height	Lifting Height	Load Capacity	Weight		Dimension	
				Mast	Platform	Stow	Operate
CM-340	970 mm	3,3 m	130kg-3,0m 120kg-3,3m	21kg	5,3kg	300x300mm	1x1,1m
CM-520	1190 mm	4,9 m	140kg-3,0m 130kg-4,0m 90kg-4,9m	38kg	5,3kg	380x380mm	1,5x1,4m

CM PORTABLE LIFTER

The CM Portable Lifter is perfect for the installation of:

- ◆ Air conditioning
- ◆ Garage door
- ◆ Awning
- ◆ Solar heating
- ◆ Any heavy load lifting...

KSF Portable Lifter CM is the multi-purpose device, essential for any business requiring the lifting & control of heavy loads for installation- i.e. air conditioners, Garage Roller Doors, Awnings..etc.

Features such as quick set-up, a level for uneven terrain and optional accessories, turn 3 men lifting jobs into a single man lifting job where safety is paramount. The KSF Portable Lifter-CM will give your business the edge over your competitors by reducing your labour cost and increasing your productivity.





Electric remote control
With Variable Speed control.

CM PORTABLE LIFTER



Emergency Stop Button



Level
Equipped to ensure the proper set up.



Manually
Manual controls available in case of a power failure.



New Retractable leg
Allows positioning against a wall.
***OPTIONAL FUNCTION!**



Telescoping Legs
Work perfect on a sloping surface or even operates on stairs.

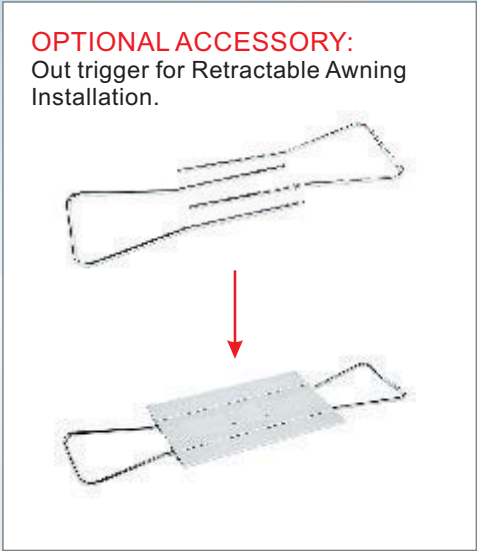

- ◆ **Telescoping Mast** made from robust aluminum, compact and reliable.
- ◆ **Telescoping Legs**, for uneven terrain such as stairway and slopes, etc. The Retractable leg allows positioning against a wall.
- ◆ Electric remote control with **Variable Speed control**.
- ◆ **Emergency Stop Button** equipped.
- ◆ **Automatic overload** safety system.
- ◆ **No tools** required for set up.
- ◆ **Set up in 30 seconds**
- ◆ **CM520H1 equipped with wheels**, easily movable to the next job site.
- ◆ Built-in level for ease of set up.
- ◆ **Manual controls** available in case of power failure.