

Replaces all previous versions

Effective 1st March 2005

**H
O
I
S
T
S**



HITACHI Electric Chain Hoists

Hitachi's reputation for excellence in design, quality, reliability and performance has made the brand a market leader the world over.

Special Features

→ Operation

Fully contactorised using high rated contactors. 'Double Insulated' pendant with mechanical interlock at buttons. 'Low Voltage' ie. 24 volts at push button contacts.

→ Safety Limits

Full current and shunt limit switches operate in both directions of hook travel.

→ Braking

Electro-magnetic disc brakes with special self-adjusting brake, and additional centrifugal brake on 'F' model.

→ Enclosure

Totally enclosed design. Entire mechanism including the motor, dual brake system, gears, rotating parts, and electrical system can be operated under the most severe conditions.

→ Chain Bucket

'Noiseless' design with flexible mounting supplied as standard.

→ Motor

Three phase squirrel cage induction motor, Class 'E' insulation. The maximum allowable temperature is 120°C (15-minute rating).

→ Overload Protection

All models are fitted with an 'Electro-mechanical' overload-limiting device.

Options

Easy to use remote control for loads where the normal pendant cable is obstructed.

Suitable for use within a four metre radius and up to an eight metre distance from the hoist.

A Fail Safe function operates if the signal is blocked or not in range.



Special Low Headroom Hoist/Trolley arrangements.

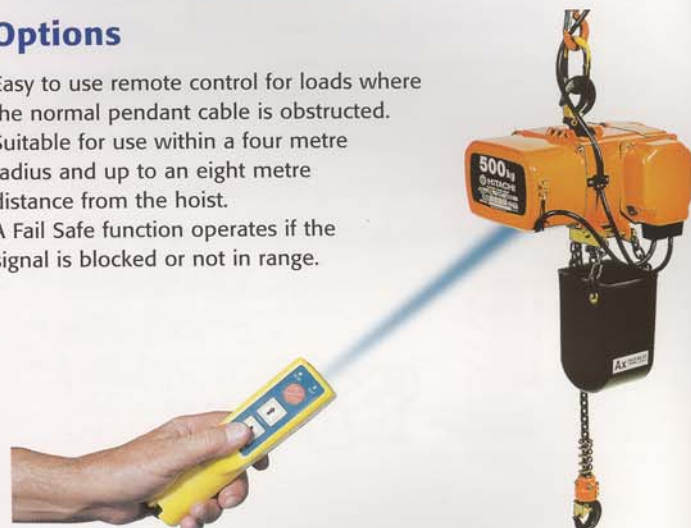

All prices/specifications subject to change without notice.

Replaces all previous versions

Effective 1st March 2005

**H
O
I
S
T
S**



Complies with Australian Standard
1418.2

Typical hoist/trolley with six button controller

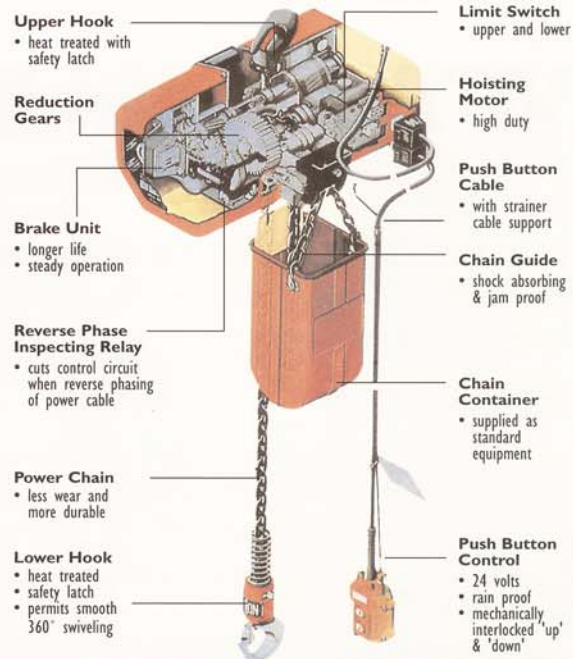

Single Phase/Single Speed

Model		1/4SI	1/2SI	1SI	2SI
Capacity	kg	250	500	1000	2000
Speed	m/min	5	3.6	2.3	1.1
Motor	kW	0.25	0.32	0.4	0.4
Weight	kg	33	34	39	51
Headroom	mm	450	450	530	645

Three Phase/Single Speed

Model		1/4S	1/2S	1S	2S	1F	2F	3F	5F
Capacity	kg	250	500	1000	2000	1000	2000	3000	5000
Speed	m/min	10	7.2	4.6	2.3	7.1	6.8	4.1	2.8
Motor	kW	0.45	0.63	0.8	0.8	1.3	2.4	2.4	2.4
Weight	kg	28	31	37	49	42	80	99	121
Headroom	mm	450	450	530	645	535	660	820	1020

Three Phase/Single and Two Speed Trolleys

Model		1ET	2ET	3ET	5ET
Capacity	kg	1000	2000	3000	5000
Travel speed	m/min	Standard	ETS	10.5	
		Fast	ETF	21.0	
		Two Speed	ETN	21.0/5.3	
Travel motor	kW	0.14		0.30	
Weight	kg	38	52	61	86
Standard beam width	mm	75-125		100-150	125-175
Min. radius	m	1.5	1.8	2.0	3.0

Three Phase/Two Speed

Model		1/4SN	1/2SN	1SN	2SN	2FN	3FN	5FN
Capacity	kg	250	500	1000	2000	2000	3000	5000
Speed	m/min	7.2/1.8	7.2/1.8	4.6/1.2	2.3/0.6	6.8/1.7	4.0/1.0	2.8/0.7
		0.32/0.08	0.63/0.16	0.8/0.2	0.8/0.2	2.4/0.6	2.4/0.6	2.4/0.6
Motor	kW							
Weight	kg	33	36	42	54	96	112	146
Headroom	mm	450	450	530	645	660	820	1020

PACIFIC Electric Chain Hoist

The perfect choice for machine shops, light manufacturing or warehousing where accurate control is required. The hoist features a light and compact aluminium housing finished in gloss yellow, double layer epoxy powder coating.

Special Features

- ➔ Compact aluminium housing
- ➔ Disc brake & overload clutch with high lifetime and easy adjustability
- ➔ High efficiency lifting motor 40% ED
- ➔ Chain bucket fitted as standard
- ➔ Low voltage pendant (48 volts)
- ➔ High protection IP54, class F insulation
- ➔ Easy to operate 2 button pendant complete with emergency stop
- ➔ Hoist rating M4

Model		PEH130	PEH135
Capacity	kgs	125	125
Chain	mm	4	4
FEM		1Bm	1Bm
Motor	KW	3ph	3ph
Speed	mpm	4	10
Falls		1	1
Weight	kgs	14	14
Headroom	mm	295	295



All prices/specifications subject to change without notice.

Replaces all previous versions

Effective 1st March 2005

JDN Flameproof Air Hoists

J.D. Neuhaus (JDN) has been manufacturing lifting equipment since 1745 and its pneumatic hoists are one of the safest and most cost efficient methods of pulling, lifting or lowering above or below ground where explosive atmospheres may occur.

Special Features

- Manufactured in Germany under strict quality control and demanding tolerances
- Low maintenance design delivers 100% duty cycle in all environmental conditions
- Only six atmospheres of compressed air required
- Immune to dust, mud, dirt, grit, heat, vapours etc.
- Self-cooling pneumatic motor will not overheat
- Fail safe brake in case of air supply failure
- Ideal for use in mines, chemical plants, paint shops etc.
- Available with push, geared or air trolley

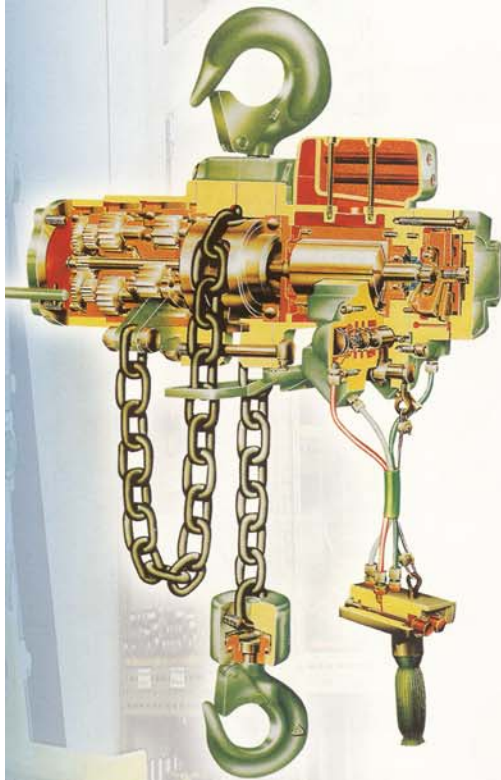

MODEL		05TS	1TS	2TS	3TI	6TI	10TI	16TI	20TI	25TI	37TI	50TI	100TI
Lifting capacity	tonnes	0.5	1	2	3.2	6.2	10	16	20	25	37.5	50	100
Number of chain strands		1	1	2	1	2	2	3	4	2	3	4	4
Motor output	kW	1.0	1.0	1.0	3.5	3.5	3.5	3.5	2.5	6	6	6	10.0
Weight at standard lift (3m)	kg	24	27	34	86	110	156	240	298	498	880	855	2460
Weight of 1m chain	kg	1.0	1.0	1.0	3.8	3.8	5.8	5.8	5.8	10.8	10.8	10.8	21.3
Chain dimension	mm	7 x 21	7 x 21	7 x 21	13 x 36	13 x 36	16 x 45	16 x 45	16 x 45	22 x 66	22 x 66	22 x 66	31.5 x 90
Air pressure	bar	6	6	6	6	6	6	6	6	6	6	6	6
Air consumption at full load	Lifting m ³ /min	1.4	1.4	1.4	3.2	3.2	3.2	2.9	5.5	5.5	5.5	5.5	11.0
	Lowering	1.2	1.2	1.2	3.8	3.8	3.8	3.8	3.7	6.5	6.5	6.5	12.0
Air connection		G 1/2	G 1/2	G 1/2	G 3/4	G 3/4	G 3/4	G 3/4	G 3/4	G 1	G 1	G 1	G 1 1/2
Lifting speed at full load	m/min	10	5	2.5	5	2.5	1.6	1	0.55	1.1	0.65	0.45	0.35
Lifting speed without load	m/min	22	11	5.5	10	5	3.2	2	1.2	2.3	1.6	1.3	0.7
Lowering speed at full load	m/min	24	12	6	10.8	5.4	3.4	2.1	1.4	1.9	1.5	1.5	0.8
Smallest headroom	mm	395	410	544	593	674	813	893	1090	1282	1466	1700	2200

TS Series
0.5 to 2 tonne

Shown with optional F1 Control

Other lift heights are available.

Air Trolleys

JDN Beam Trolleys are available to suit the range of JDN Air Hoists and can be adapted to all beam widths.

Low Headroom Type
20 - 100 tonne



TS Series
on LM Air Trolley



All prices/specifications subject to change without notice.

Replaces all previous versions

Effective 1st March 2005

Mining Applications

JDN 'B' and 'M' series air hoists have been developed for underground operations where loads must not only be lifted and lowered vertically, but also pulled horizontally.

Special Features

- ➔ Cast iron casing suitable for the roughest conditions
- ➔ Able to operate simultaneously with both hooks
- ➔ Exhaust air directed over the centre section

MODEL		M 64	M 63 D	B 48	B 612
Lifting capacity	tonnes	1 – 2	3 – 6	4 – 8	6 – 12
Lifting speed at full load	m/min	3 – 1.5	2.2 – 1.1	1.7 – 0.8	1.1 – 0.5
Lifting speed without load	m/min	8 – 4	5 – 2.5	4.2 – 2.1	3 – 1.5
Lowering speed at full load	m/min	12.5 – 6.5	6 – 3	5.8 – 2.9	3.8 – 1.9
Air consumption at full load	m ³ /min	2.0	3.2	3.5	3.5
Weight with standard lift	kg	60	100	117	192
Standard lift	m	5 – 2.5	5 – 2.5	5 – 2.5	5 – 2.5



The JDN "Economy Line"

With its patented motor-brake-system and robust aluminium housing the JDN Mini consists of only a few components to result in low and easy maintenance. Due to its small headroom and light weight the JDN Mini is easy to handle and to move.

* Pendant manipulator available.

MODEL		Mini 125	Mini 250	Mini 500	Mini 1000
Lifting capacity	kg	125	250	500	1000
Number of chain strands		1	1	1	1
Motor output	kW	0.4	0.4	1.0	1.0
Weight at standard lift (3m)	kg	9.5	10.5	21	23
Chain dimension	mm	4 x 12	4 x 12	7 x 21	7 x 21
Air pressure	bar	6	6	6	6
Air consumption at full load	Lifting	0.5	0.5	1.2	1.2
	Lowering	0.7	0.7	1.6	1.6
Air connection		G ³ / ₈	G ³ / ₈	G ¹ / ₂	G ¹ / ₂
Lifting speed at full load	m/min	15	8	10	5
Lifting speed without load	m/min	40	20	24	12
Lowering speed at full load	m/min	32	16	20	10
Smallest headroom	mm	328	328	458	458



mini
 the JDN
 Economy Series

H
O
I
S
T
S

All prices/specifications subject to change without notice.

Replaces all previous versions

Effective 1st March 2005

PACIFIC Compact Electric Rope Hoists

Designed for use on building sites and multi-storey units, these compact electric rope hoists are also suitable for a wide range of applications in warehouses, storage areas, factories, etc.

Special Features

- ➔ 240 volt single phase operation
- ➔ 5 metre power lead included
- ➔ Plug-in 10 metre push button controller
- ➔ Fail-safe braking systems
- ➔ Optional mounting arm CRH-0710
- ➔ Optional push trolley mount CRH-0720
- ➔ Raised position and reverse winding limit switch

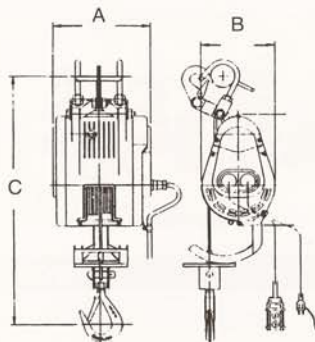
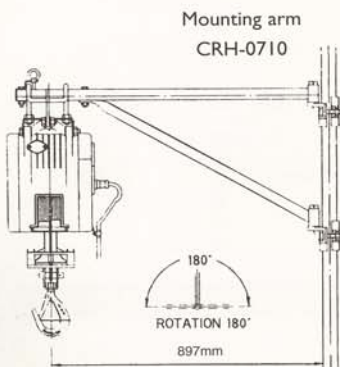
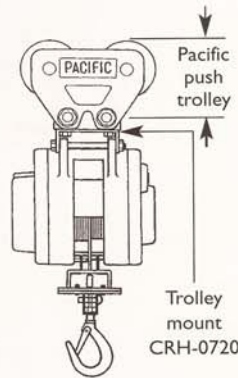

MODEL		CWS-80	CWS-160	CWS-230
Rated load	kg	80	160	230
Lifting speed	m/min	30	22	14
Power supply		240V I Ø 50 Hz		
Motor	kW	0.8	1.2	1.3
Lifting height	m	35	40	24
Wire rope	ømm x m	3.3 x 36	4 x 41	5 x 25
Net Weight	kg	9	14	15
Dimensions	A	mm	200	244
	B	mm	168	182
	C	mm	605	640

PACIFIC Pipe Trolley

Designed for pipe beams, light weight and painted finish.

Model	PPT203	
Capacity	kgs	300
Pipe diameter	mm	60
Weight	kgs	2.5

A	B	C	D	E	F	G
147.5	160	22	68	160	60	17

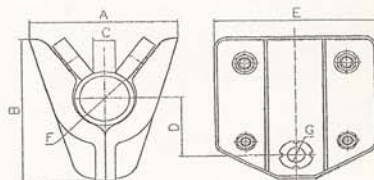

All prices/specifications subject to change without notice.